



# R-31 S

Northwest & Luxury Editions



## Specifications

Length overall (rigged)	34' 10"		10.62 m
Draft	30"		0.76 m
Beam	10'		3.05 m
Bridge clearance (mast down)	10'		3.05 m
Bridge clearance (mast up)	13' 10"		4.22 m
Height on trailer (mast down, estimated)	13' 6"		4.11 m
Length on trailer (estimated)	.41'		12.5 m
Fuel capacity	180 US gal		681.4 L
Water capacity	60 US gal		227.1 L
Hot water capacity	11 US gal		41.6 L
Waste capacity	40 US gal		151.4 L
Weight, dry	12,000 lbs		5,443 kg
Engine	Volvo D4 320 HP common rail diesel engine		



The R-31 S shares many of the features and qualities of her smaller sisterships but some notable additions to this larger model make her ideal for extended cruising while still being a trailerable trawler. The builders at Ranger Tugs equipped the foredeck with seating and a table that can be raised or lowered depending on whether the boat is under way or at anchor or dock for entertaining. In addition to the foredeck seating, the R-31 boasts a larger cockpit area with wrap-around seating utilizing seats that fold out of the gunwale. When not entertaining, seats are folded leaving the cockpit unencumbered.

The interior layout of the R-31 S features two staterooms—one large island berth forward with en suite head and a midship berth and day head. Those who are familiar with Ranger Tugs models will recognize the galley layout and helm station that maximize interior space. A starboard side door provides easy access from the helm to the side decks so crew can get to the bow for line handling.

Like all Ranger Tugs, the R-31 S comes essentially turnkey with standard features and equipment intended to make her owner's experience hassle-free and allow for ease of handling and comfort under way. Standard equipment includes bow and stern thrusters and a Volvo D4 320 HP engine that achieves a 16 knot cruise speed.

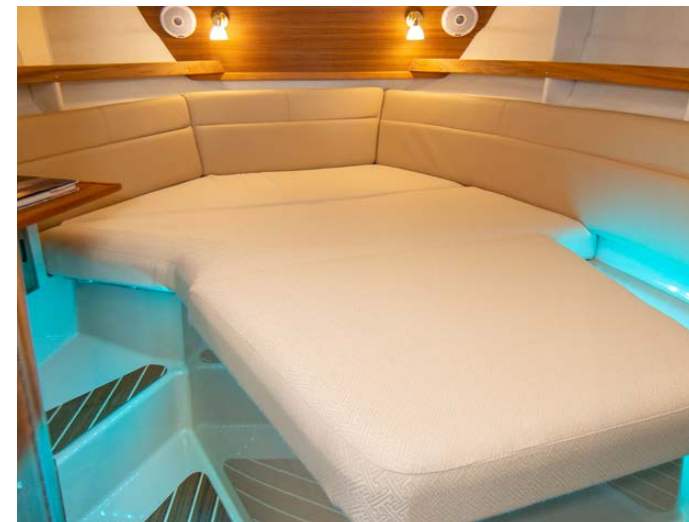
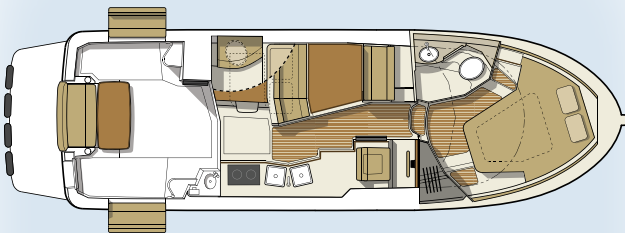

## Model Features

### Garmin 8616xsv Chartplotter with xHD Radar

A full navigation package from Garmin including the large 8616xsv GPS chartplotter with sonar and xHD radar is standard equipment on the R-31 S. Easily monitor fuel flow, engine data, bottom conditions, GPS location, tides and much more.

### Multifunction Seating

Innovative, one of a kind, expanding gunwale seats transform the cockpit into a social area, with seating for six+ and a beautiful wood table. True to Ranger Tug's DNA, all the seating in the R-31 S maximizes available space and usability.

### Full Galley

The full galley aboard the R-31 S is a chef's dream, featuring a propane stove and oven with broiler, double basin sink with pull-out rinse faucet, cutting board, silverware and utensil drawers, large cabinets, refrigerator/freezer combo, 110v outlet, wine/water cooler and microwave.

### Solar Panel

The included solar panel helps to keep your batteries charged while you're boating off-grid. Now you can go further and stay longer without the need for shore power or a generator.

### Bow and Stern Thrusters

Included bow and stern thrusters make docking and close quarters maneuvering a breeze. The wireless thruster remote allows for additional flexibility and control.

### Helm Door

The R-31 S features a full-size helm door allowing convenient access to the bow and easy fender and line handling.

### Midship Stateroom

The midship stateroom aboard the R-31 S is large enough to comfortably sleep two and features a day head as well as a hanging rack for additional storage.

## Standard Features

### Performance

320 HP Volvo D4 diesel inboard

**Electric trim tabs**

**Bow and stern thrusters**

**Thruster wireless remote**

Trailerable - 10' beam

### Accommodations & Interior Comfort

**Air conditioning (Luxury edition)**

Cabin drink holders, 4

Cabin heater (engine)

Curtains for privacy

Dinette (seats 5) converts to bed

Fully enclosed head

**Fusion stereo system (multi-zone)**

Hatches, pilothouse roof,  
solar reflective, 4

Hatches, stateroom, 1

**Heater (NW: diesel,  
Luxury: AC reverse cycle)**

Indirect cabin lighting

Island bed

**LED lighting**

**Electric marine toilet  
w/ holding tank, pump out**

**Memory foam mattress**

Midship stateroom

Opening portlights, 2

Private forward stateroom

Shower with enclosure

Storage under mattress

**TV in salon**

**TV in stateroom**

### Deck Features

**Anchor package, 22 lb, 50' chain,  
200' line**

Bow lounge seating, 2

**EVA foam traction decking**

Forward line storage

**Bolded items: High value features included in the price of the Ranger Tugs R-31 S.**  
Other manufacturers oftentimes list these features as options with an additional cost.

Rod holders, 2

**Sport racks, stainless steel**

Swimming ladder, stainless steel

Swim step, with built-in fenders

**Washdown system**

**Windlass, bow and helm controls**

### Cockpit

**Cockpit cover, hard-top  
w/ hatches and lights**

Cockpit drink holders, 5

**Cockpit refrigerator**

Cockpit seating, 6+

**Cockpit sink**

Cockpit table

**Downrigger plugs and pads  
(NW edition)**

Fold-out gunwale seating

**Powered engine hatch**

Transom entry door for boarding

### Helm

**AIS receiving**

**Color engine display**

**Digital fuel flow data**

**Electronic shift and throttle control,  
single lever**

**Garmin autopilot**

**Garmin 8616xsv navigation system  
w/ GPS and sonar**

**Garmin radar, xHD**

Helm drink holder

Sliding helm door

USB charging ports

**Windshield wipers, 4**

### Galley

Cutting board

Galley cabinets, 4

Galley drawers, 4

**Microwave**

Offset galley for clear walkway

Oven, propane

**Refrigerator/freezer**

**Sink with hot and cold water, double  
basin, with pull-out rinse faucet**

**Stove top, propane**

**Wine/water cooler**

### Mechanical & Electrical

AC electrical panel

Batteries

Battery charger

DC electrical panel

**Generator, diesel (Luxury edition)**

**Inverter**

**Macerator discharge**

30A SmartPlug inlet and 50' shore  
power cord

**Solar panel, 175w with controller**

**Underwater lights**

### Safety

Carbon monoxide detectors

**Courtesy lights**

Electric horn

Illuminated compass

Navigation lights

**Safety kit: fenders, lines, flares,  
fire ext, first aid kit, life jackets,  
boat hook**

**Spotlight with remote**

**Swim platform rails**

**VHF radio, DSC capable**

Window defrosters

### Construction

Bonded electrical system

Foam-filled fiberglass stringer grid system

**Premium hull color, Midnight Blue**

Seawater strainer(s)

Self bailing cockpit

Stainless steel cleats, rails, hardware

Vinylester barrier coat



# Ranger Tugs R-31 S Packages

The Ranger Tugs R-31 CB is sold fully equipped and ready to cruise with an expansive selection of premium features and outfitted in one of two packages:

## Northwest Edition

Most commonly used in colder climates where air conditioning would not be necessary. Equipped with diesel forced air heater, and downrigger plugs & pads.

## Luxury Edition

Most commonly used in warmer climates where air conditioning is a must. Equipped with air conditioning/reverse cycle heating, and diesel generator w/ sound shield.

## Scan Code for Pricing and Specifications



Options, freight & taxes extra.  
Prices, specifications, equipment, and options may change without notice. Information on this sheet should not be used for navigation. <sup>0524</sup>



## Additional Factory Options

- Aft cockpit sun and sunset shades
- Aft steering, second station with electronic controls
- Carpet runner, interior
- Cockpit freezer (in lieu of cockpit refrigerator)
- Dinghy, inflatable RIB 290 CSM hypalon with Weaver davits, stand-off & winch
- Factory Delivery Experience
- Garmin GXM Weather Antenna
- Hull color upgrade (from standard Midnight Blue)
- Low speed module
- Volvo Five Year Extended Coverage



47 37th st NE  
Auburn, WA, 98002  
253-839-5213

[www.RangerTugs.com](http://www.RangerTugs.com)

